



GSM intercom

SECURE YOUR ACCESS WITH
SIMPLICITY AND RECEIVE YOUR
INTERCOM CALLS ON YOUR
TELEPHONE LINE OR MOBILE PHONE
VIA GSM NETWORK

Xless
Wireless intercom

Our Xless range make it easy to establish
communication between an intercom and a
phone.

SCHEMATIC (SEE PAGE 57)



- > Indoor or outdoor interfaces installation
- > GSM intercom solutions compatible with all Castel telephone entry systems.
- > Receiving calls from your intercom directly on your phone
- > Automatic transfer if no response or line busy
- > Remote access at any time from your phone
- > Ambient noise reduction function
- > 7 recordable voice messages
- > List of authorized numbers

GSM

1 IPS2 interface
for 1 or 2 Castel intercoms

Standard GSM
network compatible

Hands-free duplex
conversation

Interface - intercom
wiring: 2 pairs 9/10

Remote door release relay in
interface

Power supply
included in interface

Interface programming via sms or web



MAIN APPLICATIONS

Tertiary industry and industrial buildings
access, day/night calls (hotel chains,
chemists, emergency services, etc.),
information terminals (pedestrian zones/
vehicle access), and many other customised
applications available.

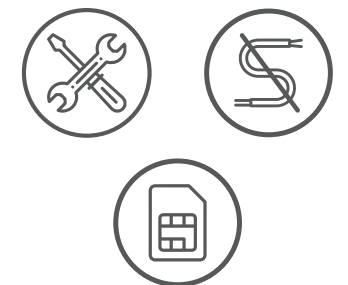
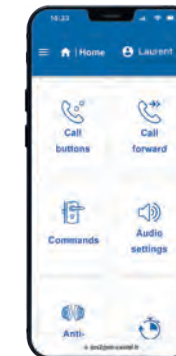

MAIN BENEFITS

Quick and easy installation

- > No major work required and wiring using GSM network
- > One interface (IPS2 GSM) to manage 1 or 2 intercoms
- > Interface compatible with all Castel telephone intercom systems

Simplified configuration

- > Settings from dedicated webpage
- > Multiple users can be imported and/or exported
- > Simple and intuitive menu
- > Easy programming of standards functions: calls, call forwarding, remote controls, etc.

Wireless and economical technology

- > Reduce installation time and control your budget
- > Independent intercom system with SIM card
- > Ideal for remote access or long distances between entrance and building

A solution compliant with disability regulations (DDA)

- > With intercom stations fitted with three pictograms viewed with coloured LEDs, and audible messages
- > An induction loop is directly integrated into intercom stations and keypads have buttons with Braille



INTERFACES



IPS2 GSM
GSM interface
REF 670.0000

- > Management of 1 or 2 GSM intercom stations
- > Enables communication between the intercom station and a telephone
- > Equipped with an antenna
- > Programming performed either by telephone keypad (DTMF) during communication with the product, or by SMS, or by a dedicated mobile web application
- > SIM card not included



IPS2 GSM EXT
Outdoor GSM interface
REF 670.1000

- > Management of 1 or 2 GSM intercom stations
- > Enables communication between the intercom station and a telephone
- > Specific box for outdoor use
- > Equipped with an antenna
- > Programming performed either by telephone keypad (DTMF) during communication with the product, or by SMS, or by a dedicated mobile web application
- > SIM card not included

AUDIO INTERCOMS



XLESS AUDIO 1B
Audio intercom station with 1 call button,
anti-vandal and DDA compliant
REF 620.0000

- > Stainless steel 316 L vandal proof front panel
- > 1 call button and label
- > 3 leds for DDA compliance
- > Integrated induction loop
- > IP65 – IK09 rating
- > Power supplied by the IPS2 GSM interface
- > • H 280 mm x W 120 mm x D 2 mm (flush-mounted with flush box D 48 mm)
- > • H 280 mm x W 120 mm x D 60 mm (surface mounted)



XLESS AUDIO 2B
Audio intercom station with 2 call buttons,
anti-vandal and DDA compliant
REF 620.1000

- > Stainless steel 316 L vandal proof front panel
- > 2 call buttons and labels
- > 3 leds for DDA compliance
- > Integrated induction loop
- > IP65 – IK09 rating
- > Power supplied by the IPS2 GSM interface
- > • H 280 mm x W 120 mm x D 2 mm (flush-mounted with flush box D 48 mm)
- > • H 280 mm x W 120 mm x D 60 mm (surface mounted)



XLESS AUDIO 4B
Audio intercom station with 4 call buttons,
anti-vandal and DDA compliant
REF 620.2000

- > Stainless steel 316 L vandal proof front panel
- > 4 call buttons and labels
- > 3 leds for DDA compliance
- > Integrated induction loop
- > IP65 – IK09 rating
- > Power supplied by the IPS2 GSM interface
- > • H 280 mm x W 120 mm x D 2 mm (flush-mounted with flush box D 48 mm)
- > • H 280 mm x W 120 mm x D 60 mm (surface mounted)



XLESS AUDIO 1B CLAV
Audio intercom station with 1 call button
and keypad, anti-vandal and DDA compliant
REF 620.3000

- > Stainless steel 316 L vandal proof front panel
- > 1 call button and label
- > Numerical keypad for direct dial and access code, buttons with braille
- > 3 leds for DDA compliance
- > Integrated induction loop
- > IP65 – IK09 rating
- > Power supplied by the IPS2 GSM interface
- > • H 280 mm x W 120 mm x D 2 mm (flush-mounted with flush box D 48 mm)
- > • H 280 mm x W 120 mm x D 60 mm (surface mounted)

ACCESSORIES

CEINTURE XLESS
Stainless-steel surface-mounting housing
REF 620.9000

KIT GRIFFES XLESS
Mounting kit for installation on plaster-board
REF 620.9100

ANTENNE DEPORTEE
Remote antenna with 10 m connection cable
REF 670.1500

SCHEMATIC

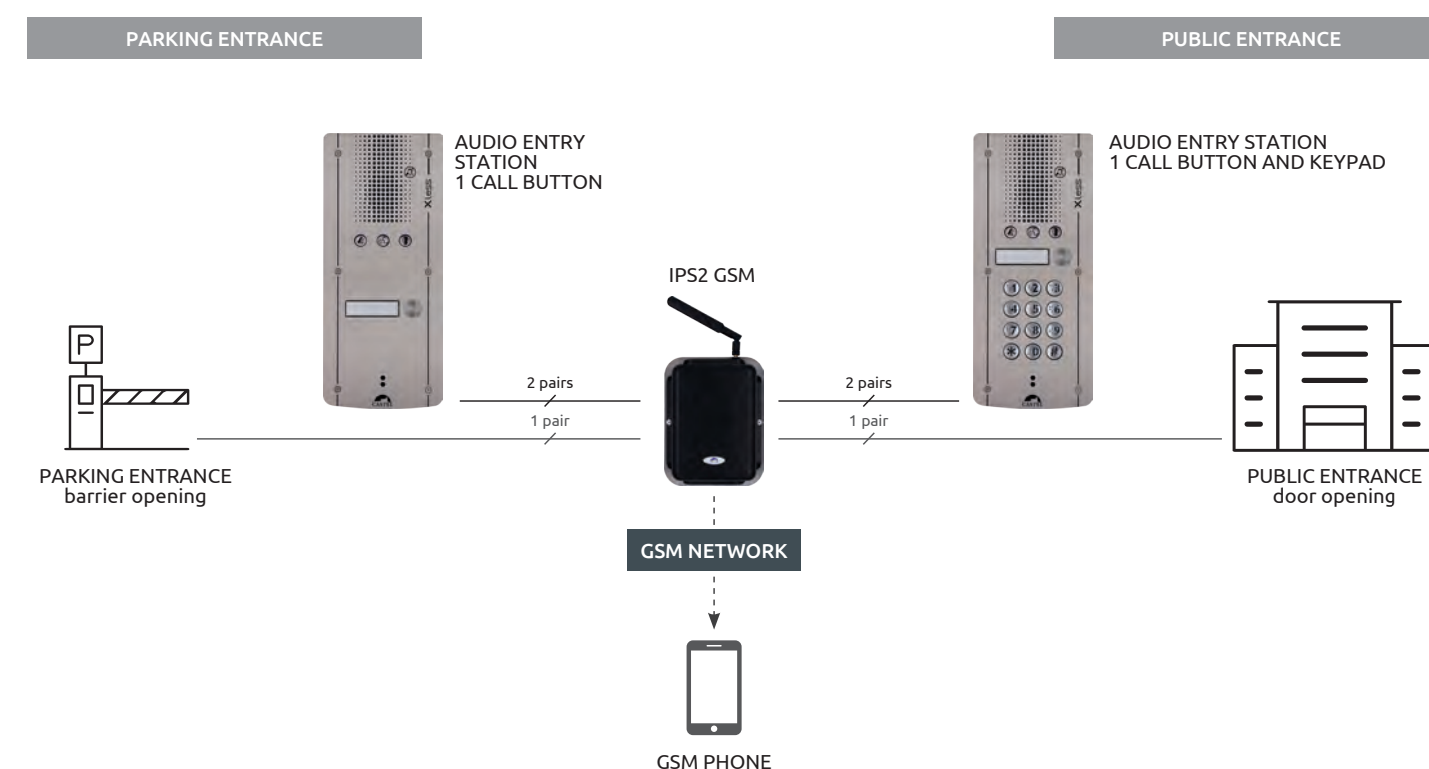

2 pairs 9/10 twisted cable. Maximum distance between entry stations and IPS2 GSM interface: 1000 m.